



CRAFT CORNER

Glistening Snowflakes shaker easel card

Our crafts writer **Sara Davies** shows you how to make a wonderful winter birthday or Christmas card

Hello and welcome to my Craft Corner! Every month I share two new projects with *Choice* readers – one for those who enjoy hobbies such as papercrafting, upcycling and decoupage, and one for those who are fond of sewing and needlecraft, where I focus on simple, everyday stitched fabric accessories.

I've lived and breathed crafting for as long as I can remember. I have very fond memories of cake decorating, cross-stitching and candle-making with my mum, and in my late teens I discovered the joy of cardmaking.

I was fortunate enough to turn my favourite pastimes into my career by setting up Crafter's Companion out of my university bedroom, and it's been an amazing journey seeing my business develop into what it is today.

I love experimenting and using our products for a whole variety of crafts. Our range of mixed-media dies can be used to create beautiful home décor items such as canvases and decorative storage solutions. Mixing and matching my Signature collections can make some wonderful personalised gifts, and our range of Threaders fabrics is ideal for curtain making, quilting, dress making and more.

My aim is to show you how easy (and rewarding) it is to create your own handicraft items, so grab a cuppa and read on to be inspired.

Find out more at (www.crafterscompanion.co.uk) or visit one of our retail stores at Newton Aycliffe, Chesterfield and Evesham.

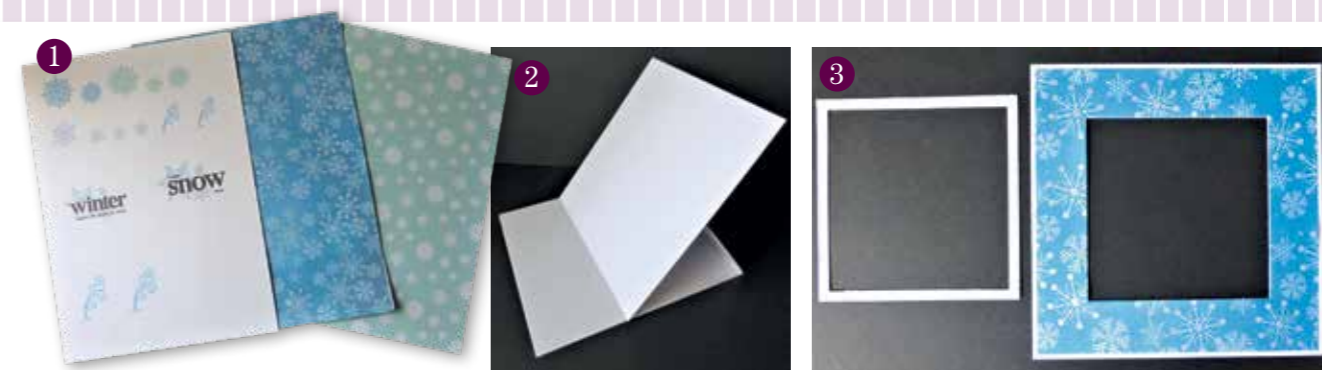

To create:

1 Print off on printable white card two co-ordinating background papers and a selection of embellishments and a sentiment

2 From 300gsm white card, cut one piece to 5¼in x 11½in. Score on the long side at 3in and 5¾in to create the base card. Cut a second piece to 5¼in x 5¾in and adhere this to the base card to make the easel

3 Cut a panel of white 300gsm card to 5¼in x 5¾in and mat a piece of patterned paper measuring 5½in x 5½in on top. Cut a 4in square aperture in the middle and a frame of the white card to fit around the edge of the aperture. You can use a ruler and kraft knife to do this or a set of Nesting Square Dies

4 Add panels of co-ordinating patterned paper measuring 5½in x 5¾in to the easel front and base, along with a sentiment panel from your printable embellishments. Create a stopper for your easel

from white card measuring 1½in x 5¾in with a strip of patterned paper on top. Adhere this to the base of your easel with foam tape

5 Adhere a piece of 5½in x 5½in acetate to the back of the aperture panel then add a border of foam tape, ensuring that the foam tape will be deep enough for your sequins to move about freely. Add a small heap of sequins on top of your sentiment panel and sandwich them with the acetate aperture panel to create the shaker element

6 Fussy-cut your embellishments, add gems and arrange on the front of your card around the aperture with 3D glue gel. Finish with a ribbon bow.

TOP TIP

This style of card would make a great winter birthday card or a Christmas card. Change the colour scheme to fit with the sequins you have got, or why not create a matching shaker panel on the top of a gift box?

Supplies:

- Free Glistening Snowflakes Downloadable Papers and Embellishments from: (www.crafterscompanion.co.uk/choice-magazine-papercrafting)
- White 300gsm card for card base
- White printable card
- Nesting Square Dies (or a ruler and Kraft Knife)
- Acetate
- Gems
- Sequins
- 3D glue gel
- Fingerlift tape
- Foam pads
- Scoremaster scoreboard



Get Sewing

Seasonal table runner

To create:

1 Use the 3.5in square and half square triangle dies from Build a Block die set to cut the following pieces:

- White - 24 x 3.5in squares
24 x 3.5in half square triangles
- Red -15 x 3.5in squares

- Green -12 x 3.5in squares
- Dark red - 24 x 3.5in half square triangles

2 Using a 0.25in seam allowance, stitch your half square triangles together

3 Lay out the pieces to make your first block following the diagram below

4 Sew the block together one row

at a time and then complete by sewing all the rows together. Press and set the seams carefully as you go

5 When your block is complete, press carefully and repeat to make a further two blocks. Once all the blocks are complete, align the seams and stitch together in a row to make the top of your table runner

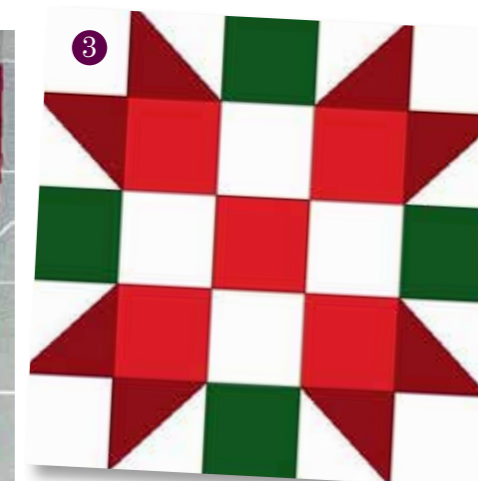

Supplies:

- 0.5 metres of each of red, dark red and green quilting fabric
- One metre of white quilting fabric
- 0.5 metres of cotton wadding
- Gemini Build-a-Block set
- Gemini Die cutting machine
- Threaders Stick and Spray for fabric
- Basic sewing kit

6 Make a quilt sandwich with the white backing fabric face-down, then the wadding and the runner top face-up. Baste the layers together using the Threaders Stick and Spray for fabric

7 Quilt as desired (this project features a stippling effect). Trim the edges of the runner

to remove excess wadding and backing fabric

8 Use 2.5in strips of green fabric to make your quilt binding and stitch to the edge of the runner, mitring the corners as you go

9 Hand-stitch in place on the back of the runner to complete.